

Non-combustible solid aluminium cladding



A new standard in façade technology

Product features

- Non-combustible solid aluminium sheet
- Concealed fixings
- Design flexibility provided by jointing and corner profiles
- Boot gasket assists with both acoustic and water performance
- Warranties provided for the complete system with recommended panels
- Onsite backup and technical support
- Two system options available – standard and captive
- Wide range of colour options
- Fully patent protected system – Australia, New Zealand, China and USA
- Red Dot Design Award – Honourable Mention 2008

Testing Performance

- AS1530.1 Non Combustibility test
 - Non Combustible
- AS1530.3 Fire Hazard Properties
 - Smoke development Index of <3
 - Spread of flame index of 0
- AS4284-1995 Water performance testing of a Facade System
 - Serviceability Limit State: 3,000Pa
 - Ultimate Limit State: 4,500Pa
 - Water penetration: 900Pa
- AS4040.3 Cyclonic strength
 - Wind capacity: 7,900Pa





Two systems available

Standard Captive

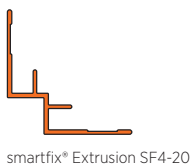
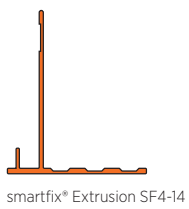
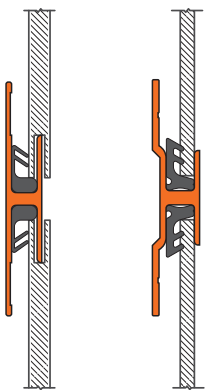

The smartfix® system is fixed and glued onto top hats that are fitted to the building structure at 600mm centres, either vertical or horizontal

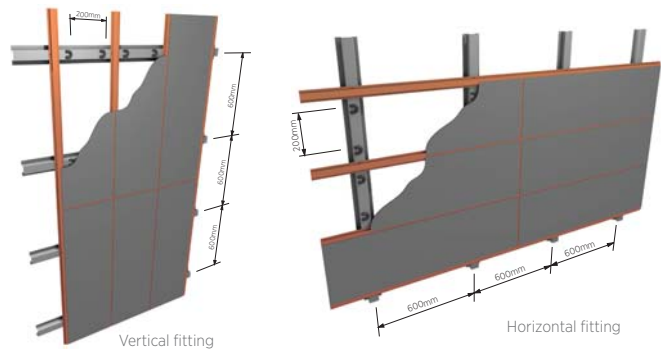

- a. smartfix® SF4 solid plate 4mm aluminium facade panel
- b. 50 x 35 x 1.1mm top hat section
- c. smartfix® SF4 - pressure gasket
- d. Wafer head tek screws
- e. Firefly non-combustible sarking between top hat and support structure
- f. Main support structure
- g. Structural adhesive H.B Fuller
- h. Packer as required
- i. Aluminium angle
- j. Corking and sealing

