

PRODUCT BULLETIN No. 245
AGS 300 & 325 Nailing Fin Frames
Commercial - Residential

Capral is pleased to be introducing four new extrusions for the Residential & Architectural market. These extrusions are the reveal fin version of the 300 and 325 Series Framing Systems (EP2206, EP12852, EP2205 & EP12853), utilizing 76mm commercial frames/windows/doors for residential applications.

These additions allow easy and quick fabrication with reveals, also working with EP9487 76mm Revealed Sub Sill Sub sill.

When reveal products 311592 Reinforced Foil tape should be used on the corner junction

Refer to Product Bulletin 144 for further information.

311592
REINFORCED FOIL TAPE
50m ROLL
(PT018)

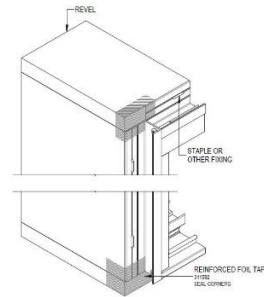
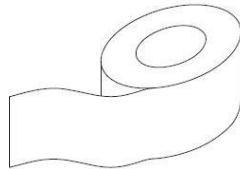

	<p>Section – EP18378</p> <p>Description – AGS 300 SG Reveal Frame</p> <p>Paint Perimeter – 352mm</p> <p>Anodised Perimeter – 528mm</p>
	<p>Section – EP18376</p> <p>Description – AGS 300 SG Reveal Sill/Transom</p> <p>Paint Perimeter – 299mm</p> <p>Anodised Perimeter – 448mm</p>

	<p>Section – EP18379</p> <p>Description – AGS 325 DG Reveal Frame</p> <p>Paint Perimeter – 342mm</p> <p>Anodised Perimeter – 512mm</p>
	<p>Section – EP18377</p> <p>Description – AGS 325 DG Reveal Sill/Transom</p> <p>Paint Perimeter – 296mm</p> <p>Anodised Perimeter – 443mm</p>

These are currently in stock in selected locations, please check with your account manager for details

Technical Notes

- Technical Manuals are updated and published for download from the Capral website and Capral Hub app.
- These new sections are available in the next software packages updates, please run your systems update to access these sections

Please contact your local Capral representative for further information.

Kind regards,

Matthew Finnie

National Manager – Window & Door Systems